

DATE: 07-20-07  
DRAWN: J. WARDEN  
CHECKED: J. WARDEN  
APPROVED: J. WARDEN  
FILE NAME: S:\VARDEN\PROJECTS\033 - FRAMES\DWG\033 - FRAMES\033 - STANDARD\033 - STANDARD.DWG

**NOTES:**  
Below is the suggested post and girt spacing layout for one end when using steel gable framing kit (optional). This kit contains sufficient lengths of 2" square steel tubing to be field cut as per cutting schedule.  
Any deviations from noted post spacings will alter these lengths and may result in insufficient amounts of tubing.

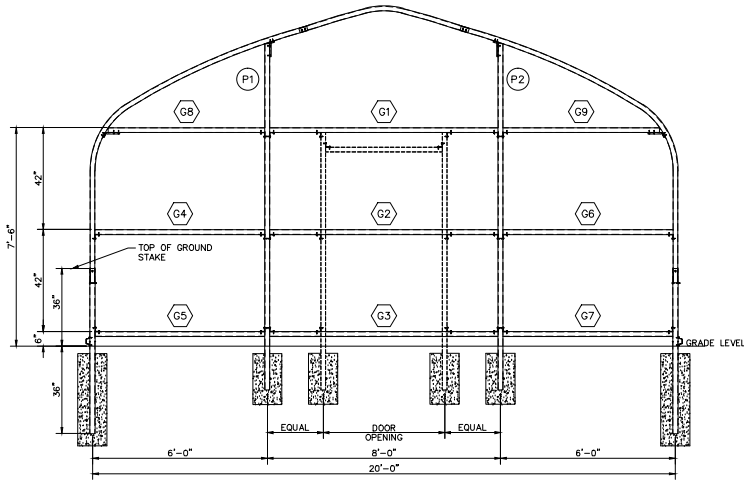

**A 6'-0" END FRAMING**  
SCALE: N.T.S.

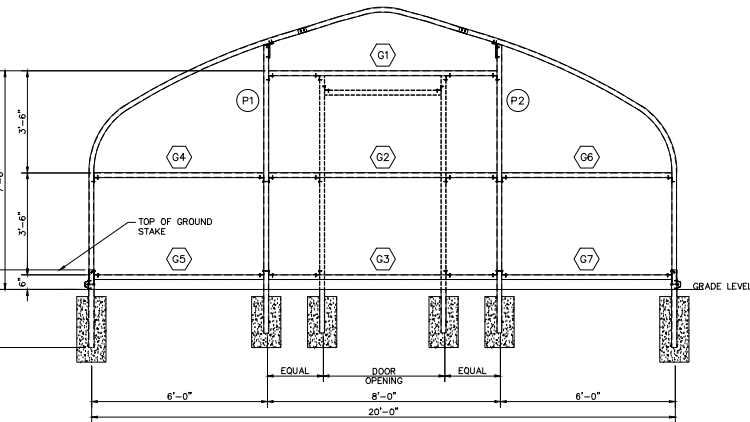

**D 4'-0" END FRAMING**  
SCALE: N.T.S.

**POST & GIRTS CUTTING SCHEDULE**  
(4 PIECES OF 2" SQ TUBE @ 288")  
(VERIFY LENGTHS IN FIELD)



P1 THRU P2 = 144" (12'-0")  
G1 THRU G3 = 94" (7'-10")  
G4 THRU G9 = 70" (5'-10")

**C POSTS & GIRTS**  
SCALE: N.T.S.

**POST & GIRTS CUTTING SCHEDULE**  
(3 PIECES OF 2" SQ TUBE @ 288")  
(VERIFY LENGTHS IN FIELD)



P1 THRU P2 = 120" (10'-0")  
G1 THRU G3 = 94" (7'-10")  
G4 THRU G7 = 70" (5'-10")

**F POSTS & GIRTS**  
SCALE: N.T.S.

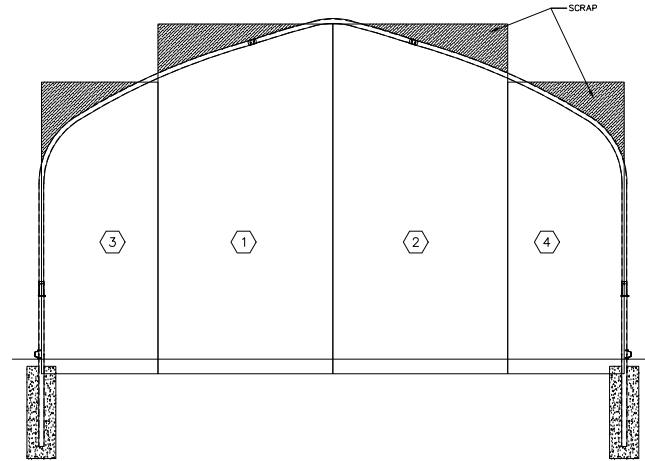

**B 6'-0" END GLAZING**  
SCALE: N.T.S.

4'-0" & 6'-0" WIDE POLYCARBONATE SHEETS  
SHEETS #1 & #2 ARE 72" WIDE x 144"(12'-0")  
SHEETS #3 & #4 ARE 48" WIDE x 120" (10'-0")  
REQUIRES 48 LINEAL FEET OF DOUBLE H-SPLICE  
REQUIRES 70 SCREWS

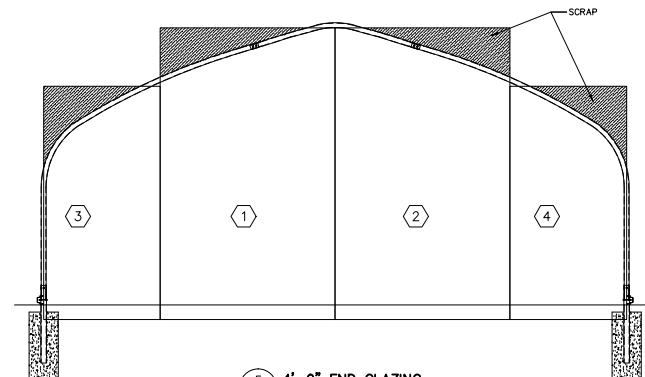

**E 4'-0" END GLAZING**  
SCALE: N.T.S.

4'-0" & 6'-0" WIDE POLYCARBONATE SHEETS  
SHEETS #1 & #2 ARE 72" WIDE x 120"(10'-0")  
SHEETS #3 & #4 ARE 48" WIDE x 96" (8'-0")  
REQUIRES 38 LINEAL FEET OF DOUBLE H-SPLICE  
REQUIRES 65 SCREWS



The designer and client in this document, and the manufacturer, accept no responsibility for the accuracy of the information contained herein. The user of this information assumes all liability for any errors or omissions. The user of this information assumes all liability for any errors or omissions. The user of this information assumes all liability for any errors or omissions.

**ENGINEER'S STAMP:**  
DESIGNER'S SEAL APPLIED TO FRONT OF STRUCTURAL COMPONENTS ONLY

**REVISION RECORD**

NO.	DATE	DESCRIPTION
1	07/20/07	
2	07/20/07	
3	07/20/07	

GOLDEN PACIFIC

PROJECT NO.:	
DRAWING NO.:	
DATE:	04/20/07
PROJECT NAME:	20FT HOUSE

**S2.01**